

# OKLAHOMA JUDICIAL CENTER Oklahoma City, OK



TAPArchitecture  
415 Broadway  
Oklahoma City, OK 73102  
Tel: 405.232.8787  
Fax: 405.232.8810  
in association with  
The Leonard Parker Associates  
430 Oak Grove #300  
Minneapolis, MN 55403  
Tel: 612.871.6864  
Fax: 612.871.6868  
Court Consultant:  
Space Management Con.  
120 S. Doherty Drive  
Beverly Hills, CA 90211  
Tel: 310.273.8388  
Fax: 310.273.7188

Structural:  
Mark Eudaley Engineering  
6555 N.W. 39th Expressway  
Bethany, OK 73008  
Tel: 405.789.4433  
Fax: 405.789.4589  
Mechanical & Electrical:  
PSA Consulting Engineers  
3031 NW 64th Street #101  
Oklahoma City, OK 73116  
Tel: 405.840.1901  
Fax: 405.840.1916

Civil:  
Smith-Roberts and Associates  
25 South Oklahoma Avenue  
Suite 400  
Oklahoma City, OK 73104  
Tel: 405.840.7094  
Fax: 405.840.9116

Landscape Architectural:  
Charles Wood and Associates  
23675 Xenadu Ave.  
Jordan, Minnesota 55352  
Tel: 612.758.3942  
Fax: 612.758.3942

Historic Preservation Architect:  
Ann Henderson, FAIA  
College of Architecture  
University of Oklahoma  
Norman, OK 73019  
Tel: 405.325.3868 ext. 3868  
Fax: 405.325.7558

Security Consultant:  
Scott Simpson, ET  
SimplexGrinnell LP  
2835 S. Utah Avenue  
Oklahoma City, OK 73108  
Tel: 405.246.1000  
Fax: 405.682.6169

Interior Design Consultant:  
Vicki VonStavern, IDA  
VonStavern Design Group, Inc.  
601 Holladay  
Edmond, OK 73003-3001  
Tel: 405.359.1757  
Tel: 405.341.4306



ISSUE DATE  
BID ISSUE 08/15/07  
SEE ADDENDUM H 07/25/08  
MILLWORK BID ISSUE SET 10/16/08  
FPE MARSHAL UPDATE SET 06/20/09

## PHASE 2 INT. COMPLETION CONSTRUCTION DOCUMENTS

scale: 1/8"=1'-0"  
drawn by: RS/H/CL  
checked by: RA/ FAK/ RS  
date: 08 / 15 / 2007  
project no: 9737.2a

## REFLECTED CEILING PLAN THIRD FLOOR

sheet number

A2.4



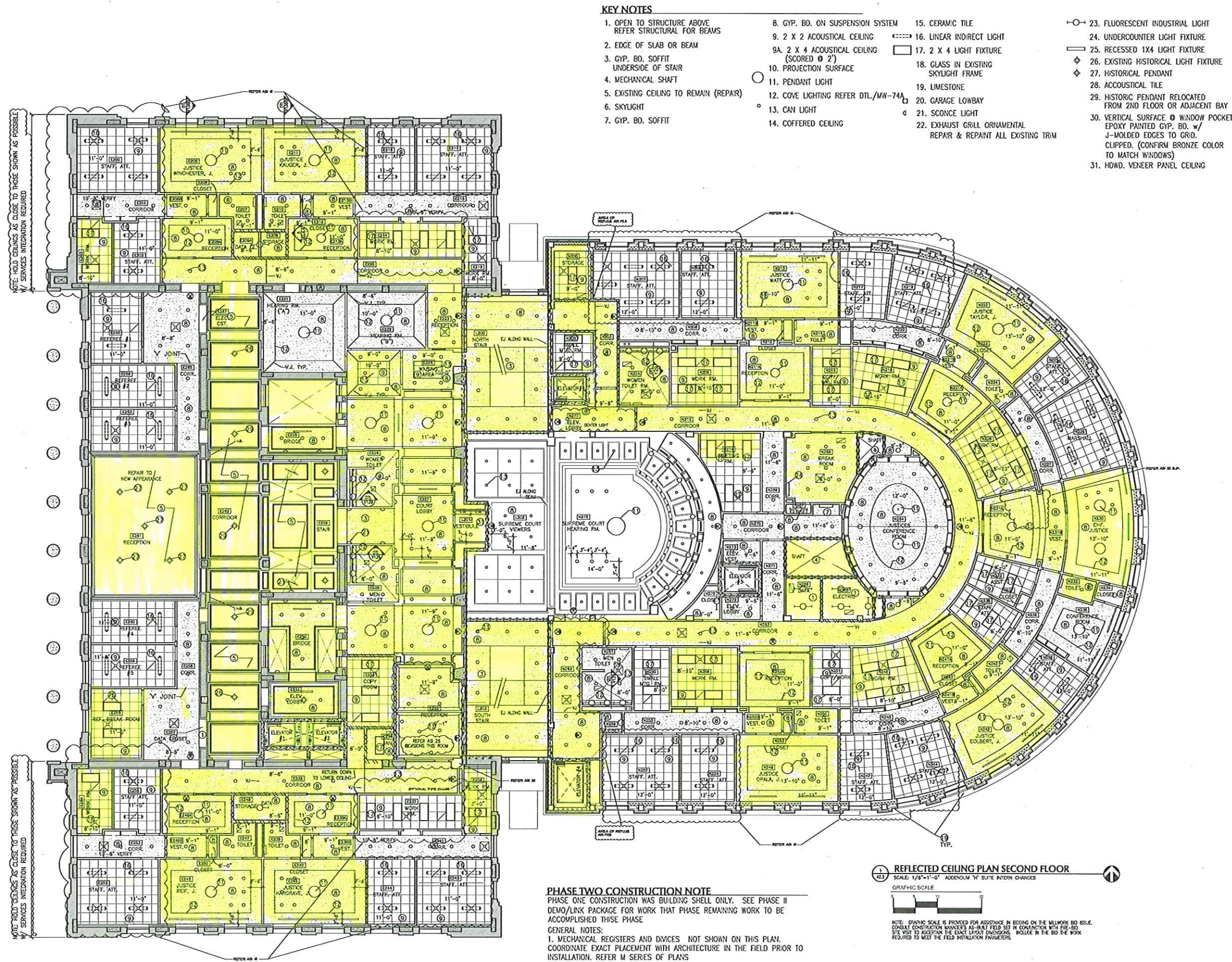

# OKLAHOMA JUDICIAL CENTER Oklahoma City, OK



TAPArchitecture  
415 Broadway  
Oklahoma City, OK 73102  
Tel: 405.232.8787  
Fax: 405.232.8810

in association with  
The Leonard Parker Associates  
430 Oak Grove #300  
Minneapolis, MN 55403  
Tel: 612.871.6864  
Fax: 612.871.6868

Court Consultant:  
Space Management Con.  
120 S. Doherty Drive  
Beverly Hills, CA 90211  
Tel: 310.273.8388  
Fax: 310.273.7188

Structural:  
Mark Eudaley Engineering  
6656 N.W. 38th Expressway  
Bethany, OK 73008  
Tel: 405.789.4433  
Fax: 405.789.4589

Mechanical & Electrical:  
PSA Consulting Engineers  
3031 NW 64th Street #101  
Oklahoma City, OK 73116  
Tel: 405.840.1901  
Fax: 405.840.1916

Civil:  
Smith-Roberts and Associates  
25 South Oklahoma Avenue  
Suite 400  
Oklahoma City, OK 73104  
Tel: 405.840.7094  
Fax: 405.840.9116

Landscape Architectural:  
Charles Wood and Associates  
23675 Xanadu Ave.  
Jordan, Minnesota 55352  
Tel: 612.758.3942  
Fax: 612.758.3942

Historic Preservation Architect:  
Ann Henderson, FAIA  
College of Architecture  
University of Oklahoma  
Norman, OK 73019  
Tel: 405.325.3868 ext. 3868  
Fax: 405.325.7558

Security Consultant:  
Scott Simpson, ET  
SimplexGrinnell LP  
2835 S. Utah Avenue  
Oklahoma City, OK 73108  
Tel: 405.246.1000  
Fax: 405.682.6169

Interior Design Consultant:  
Vicki VonStavern, IIDA  
VonStavern Design Group, Inc.  
601 Hollwade  
Edmond, OK 73003-3001  
Tel: 405.359.1757  
Tel: 405.341.4306



ISSUE: \_\_\_\_\_ DATE: 08/15/07  
BID ISSUE: \_\_\_\_\_ 07/25/08  
SEE ADDENDUM H: \_\_\_\_\_  
MILLWORK BID ISSUE SET: 10/16/08  
FIRE MARSHAL UPDATE SET: 05/20/09



KEY NOTES

1. OPEN TO STRUCTURE ABOVE  
REFER STRUCTURAL FOR BEAMS

2. EDGE OF SLAB OR BEAM

3. GYP. BD. SOFFIT  
UNDERSIDE OF STAIR

4. MECHANICAL SHAFT

5. EXISTING CEILING TO REMAIN (REPAINT)

6. NEW SKYLIGHT

7. GYP. BD. SOFFIT

8. GYP. BD. ON SUSPENSION SYSTEM

9. 2 X 2 ACOUSTICAL CEILING

9A. 2 X 4 ACOUSTICAL CEILING  
(SCORED @ 2')

10. PROJECTION SURFACE

11. PENDANT LIGHT

12. COVE LIGHTING REFER DTL/MN-74A

13. CAN LIGHT

14. NEW COFFERED CEILING

15. CERAMIC TILE

16. LINEAR INDIRECT LIGHT

17. 2 X 4 LIGHT FIXTURE

18. NEW GLASS IN EXISTING  
SKYLIGHT FRAME

19. LIMESTONE

20. GARAGE LOWBAY

21. SCONCE LIGHT

22. NEW EXHAUST GRILL ORNAMENTAL  
REPAIR & REPAINT ALL EXISTING TRIM

23. FLUORESCENT INDUSTRIAL LIGHT

24. UNDERCOUNTER LIGHT FIXTURE

25. RECESSED 1X4 LIGHT FIXTURE

26. EXISTING HISTORICAL LIGHT FIXTURE

27. NEW HISTORICAL PENDANT

28. ACOUSTICAL TILE

29. HISTORIC PENDANT RELOCATED  
FROM 2ND FLOOR OR ADJACENT BAY

30. VERTICAL SURFACE @ WINDOW POCKET  
EPOXY PAINTED GYP. BD. w/  
J-MOLDED EDGES TO GRID.  
CLIPPED. (CONFIRM BRONZE COLOR  
TO MATCH WINDOWS)

31. RETURN AIR

32. SUPPLY AIR

OKLAHOMA  
JUDICIAL  
CENTER  
Oklahoma City, OK



TAParch'tecture  
415 Broadway  
Oklahoma City, OK 73102  
Tel: 405.232.8787  
Fax: 405.232.8810

in association with  
The Leonard Parker Associates  
430 Oak Grove #300  
Minneapolis, MN 55403  
Tel: 612.871.6864  
Fax: 612.871.6868

Court Consultant:  
Space Management Con.  
120 S. Doherty Drive  
Beverly Hills, CA 90211  
Tel: 310.273.8388  
Fax: 310.273.7188

Structural:  
Mark Eudaley Engineering  
6656 N.W. 39th Expressway  
Bethany, OK 73008  
Tel: 405.789.4433  
Fax: 405.789.4589

Mechanical & Electrical:  
PSA Consulting Engineers  
3031 NW 64th Street #101  
Oklahoma City, OK 73116  
Tel: 405.840.1901  
Fax: 405.840.1916

Civil:  
Smith-Roberts and Associates  
25 South Oklahoma Avenue  
Suite 400  
Oklahoma City, OK 73104  
Tel: 405.840.7094  
Fax: 405.840.9116

Landscape Architect:  
Charles Wood and Associates  
23675 Xenadu Ave.  
Jordan, Minnesota 55352  
Tel: 612.758.3942  
Fax: 612.758.3942

Historic Preservation Architect:  
Ann Henderson, FAIA  
College of Architecture  
University of Oklahoma  
Norman, OK 73019  
Tel: 405.325.3868 ext. 3868  
Fax: 405.325.7558

Security Consultant:  
Scott Simpson, ET  
SimplexGrinnell LP  
2835 S. Utah Avenue  
Oklahoma City, OK 73108  
Tel: 405.246.1000  
Fax: 405.682.6169

Interior Design Consultant:  
Vicki VanStavern, IIDA  
VanStavern Design Group, Inc.  
601 Holladay  
Edmond, OK 73003-3001  
Tel: 405.359.1757  
Fax: 405.341.4306



ISSUE	DATE
BID ISSUE	08/15/07
SEE ADDENDUM H	07/25/08
MILLWORK BID ISSUE SET	10/16/08
FIRE MARSHAL UPDATE SET	05/20/09

PHASE 2 INT.  
COMPLETION  
CONSTRUCTION  
DOCUMENTS

scale: 1/8"=1'-0"  
drawn by: RJS/AM/CL  
checked by: RJA/ FJK/ RS  
date: 08 / 15 / 2007  
project no: 97372a

REFLECTED  
CEILING PLAN  
FIRST FLOOR

sheet number

A2.2

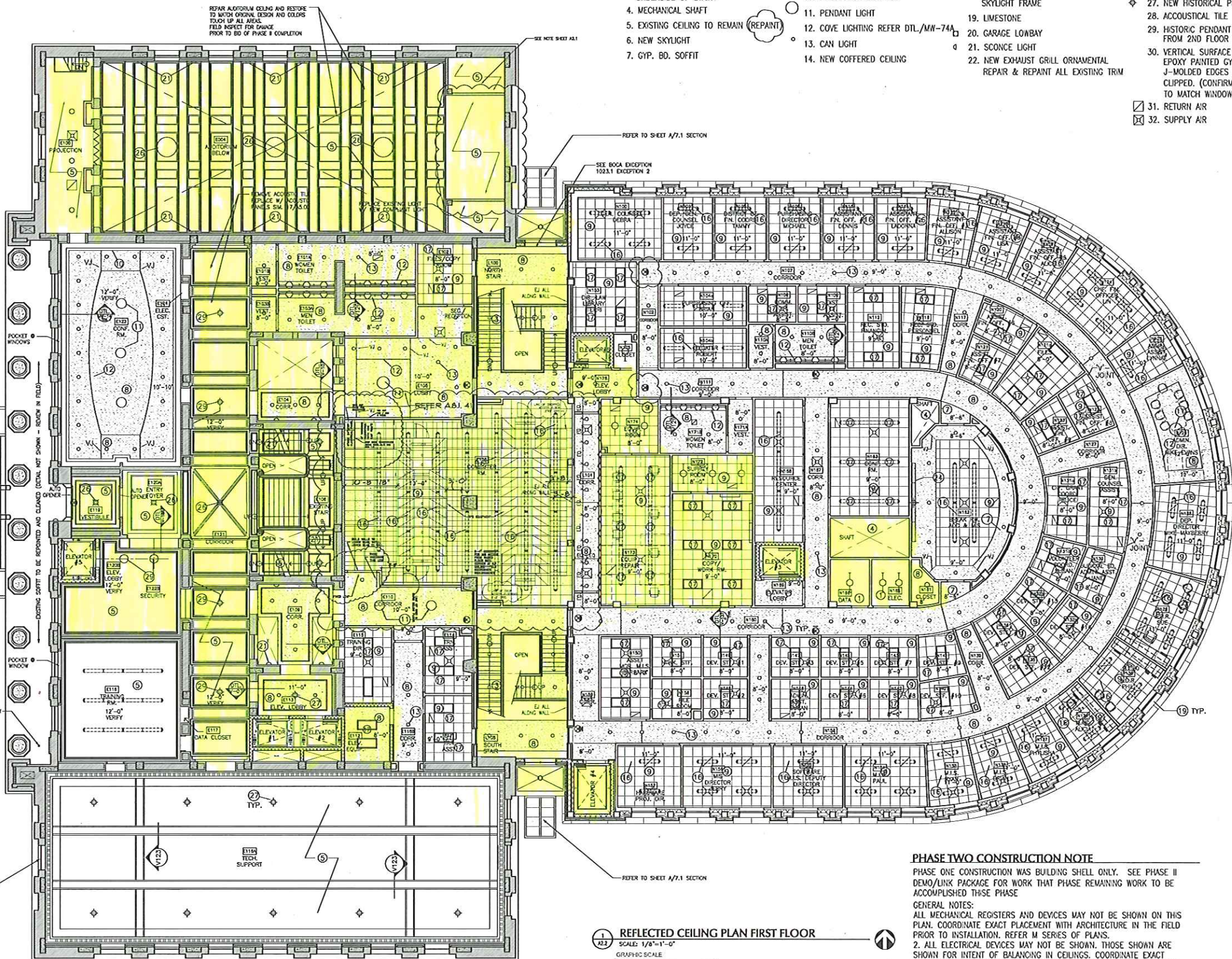

REFLECTED CEILING PLAN FIRST FLOOR

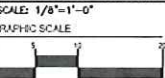

NOTE: GRAPHIC SCALE IS PROVIDED FOR ASSISTANCE IN BOOKING ON THE MILLWORK BID ISSUE. CONSULT CONSTRUCTION NUMBER'S AS-BUILT FIELD SET IN CONSTRUCTION WITH PRE-BID SITE VISIT TO ASCERTAIN THE EXACT LAYOUT DIMENSIONS. INCLUDE IN THE BID THE WORK REQUIRED TO MEET THE FIELD INSTALLATION PARAMETERS.

PHASE TWO CONSTRUCTION NOTE

PHASE ONE CONSTRUCTION WAS BUILDING SHELL ONLY. SEE PHASE II DEMO/LINK PACKAGE FOR WORK THAT PHASE REMAINING WORK TO BE ACCOMPLISHED THOSE PHASE

GENERAL NOTES:  
ALL MECHANICAL REGISTERS AND DEVICES MAY NOT BE SHOWN ON THIS PLAN. COORDINATE EXACT PLACEMENT WITH ARCHITECTURE IN THE FIELD PRIOR TO INSTALLATION. REFER M SERIES OF PLANS.  
2. ALL ELECTRICAL DEVICES MAY NOT BE SHOWN. THOSE SHOWN ARE SHOWN FOR INTENT OF BALANCING IN CEILINGS. COORDINATE EXACT PLACEMENT WITH ARCHITECTURE IN THE FIELD. REFER E SERIES PLANS.



1. OPEN TO STRUCTURE ABOVE  
REFER STRUCTURAL FOR BEAMS
2. EDGE OF SLAB OR BEAM
3. GYP. BD. SOFFIT  
UNDERSIDE OF STAIR
4. MECHANICAL SHAFT

31. EXPOSED UNDERSIDE OF STAIR.  
2 HOUR SPRAY ON CEMENTITIOUS  
FIREPROOFING REQ'D FOR STEEL  
CONSTRUCTION
32. EXACT CEILING HEIGHT TO BE  
SET IN FIELD. KEEP ALL  
ACOUSTIC CEILING SYSTEMS  
AS COMPACT & HIGH AS  
POSSIBLE TO KEEP FINISH  
CEILING AS HIGH AS  
POSSIBLE

Interior Design Consultant:  
Vicki VanStavern, IIDA  
VanStavern Design Group, Inc.  
601 Hollowdale  
Edmond, OK 73003-3001  
Tel: 405.359.1757  
Tel: 405.341.4306



scale: 1/8"=1'-0"  
drawn by: IRS/JH/CL  
checked by: R/L/ F/K/ IRS  
date: 08 / 15 / 2007  
project no: 9737.2a

## sheet number

## A2.1

